

HSE RoHS

SPECIFICATIONS

Rated Current: 7.0AMP
 Contact Resistance: 20mΩ Max
 Withstand Voltage: 1500V AC/DC
 Insulation Resistance: 1000MΩ Min
 Operation Temperature: -40°C to +105°C

Contact Material: Brass
 Contact Plating: Au or Sn Over Ni
 Insulator Material: Polyester (UL94V-0)
 Standard: PA66

注明: 带号码球的为重点尺寸

Ordering Information

JL3961S -1 XX B XX X 01

S=180° No. of Pins Per Row 2-16P Insulator Material Option B=BK-PA66 Contact Plating Insulator Color W=White E=Beige
 G0:Gold Flash
 G1:1U" Gold
 G2:1.5U" Gold
 G3:2U" Gold
 G4:3U" Gold
 G5:5U" Gold
 G6:10U" Gold
 S0:Gold Flash/Tin
 SN:Tin

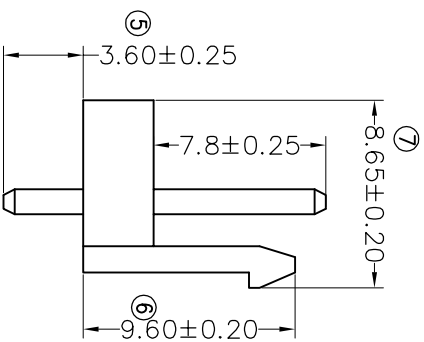
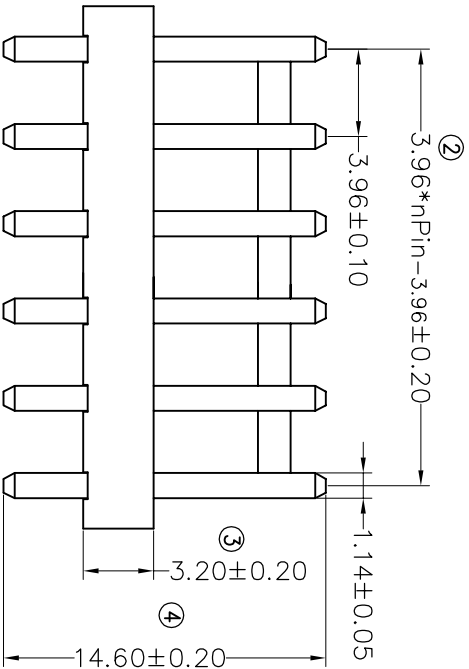
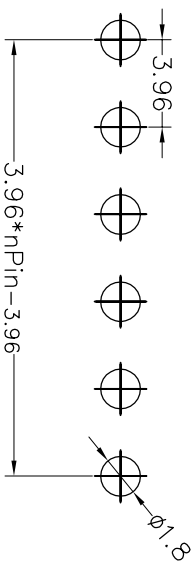
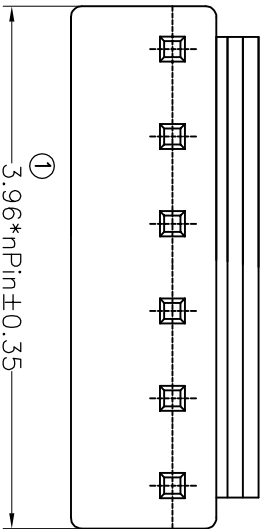

OPERATION		DRAW		SCALE		FIT		TITLE:	
DIM	TOL	APPROVE	JinChengXin	UNIT	mm	1/1	PROJ.	PART NO.	3.96 Water M-Type Npin 180°
X.X	±0.30	CHECK	16.03.28	A4		1/1		JL3961S-1XXBXX01	
X.XX	±0.20								
X.XXX	±0.10								
Angle	±3°								
DATE	MODIFICATION DESCRIPTION	CHANGE							
2016.03.28	NEW DRAWING								
REV									
A0									
1									

JIN 深圳市锦凌电子有限公司
 SHENZHEN JINLING ELECTRONIC CO.,LTD
 Tel: 86-755-2997-5806/5802 Fax: 86-755-2997-5892