

HSE RoHS

MAT'L: NYLON 66 UL94V-0
 CURRENT RATING: 5A AC, DC
 VOLTAGE RATING: 250V AC, DC
 MATES WITH: 5850 SERIES TERMINAL
 ACCEPTS WITH: 5850H SERIES HOUSING

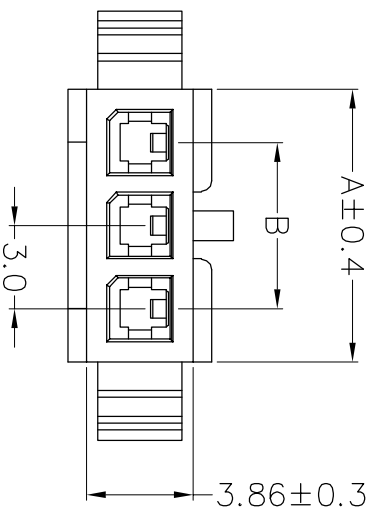

| PART NO. | A | B |
|----------|-------|------|
| 1X2P | 6.85 | 3.0 |
| 1X3P | 9.85 | 6.0 |
| 1X4P | 12.85 | 9.0 |
| 1X5P | 15.85 | 12.0 |
| 1X6P | 18.85 | 15.0 |
| 1X7P | 21.85 | 18.0 |
| 1X8P | 24.85 | 21.0 |
| 1X9P | 27.85 | 24.0 |
| 1X10P | 30.85 | 27.0 |
| 1X11P | 33.85 | 30.0 |
| 1X12P | 36.85 | 33.0 |

Ordering Information

JL 300 1 H - 1 **XX** **B** 02

No. of Pins Per Row 1*2-12P
 Insulator Color B=Black

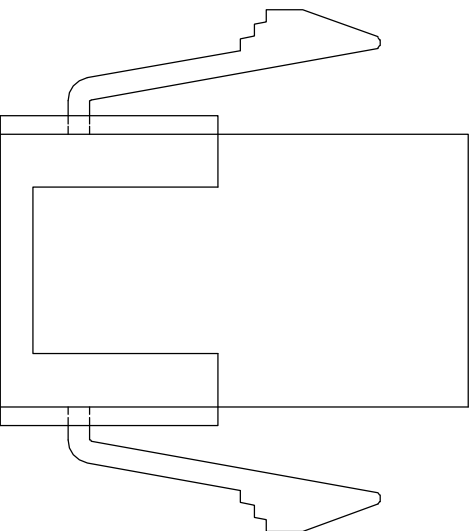

| REV | DATE | MODIFICATION DESCRIPTION | CHANGE | OPERATION | DRAW | ChenWei | 18.12.28 | SCALE | FIT | PART NO. | TITLE: |
|-----|------------|--------------------------|--------|---------------------------------------|---------------------------------------|---------|----------|------------|-----------|----------------|----------------|
| A0 | 2018.12.28 | NEW DRAWING | | X.XX X.XX X:XXX Angle DIM | ±0.30 ±0.25 ±0.20 ±3° TOL | CHECK | | UNIT mm | A4 1/1 | JL3001H-1XXB02 | MX3.0 1xNP 母胶壳 |
| 1 | | | | | | | | | | | |

JILIN 深圳市锦凌电子有限公司
 SHENZHEN JINLING ELECTRONIC CO.,LTD
 Tel: 86-755-2997-5806/5802 Fax: 86-755-2997-5892